

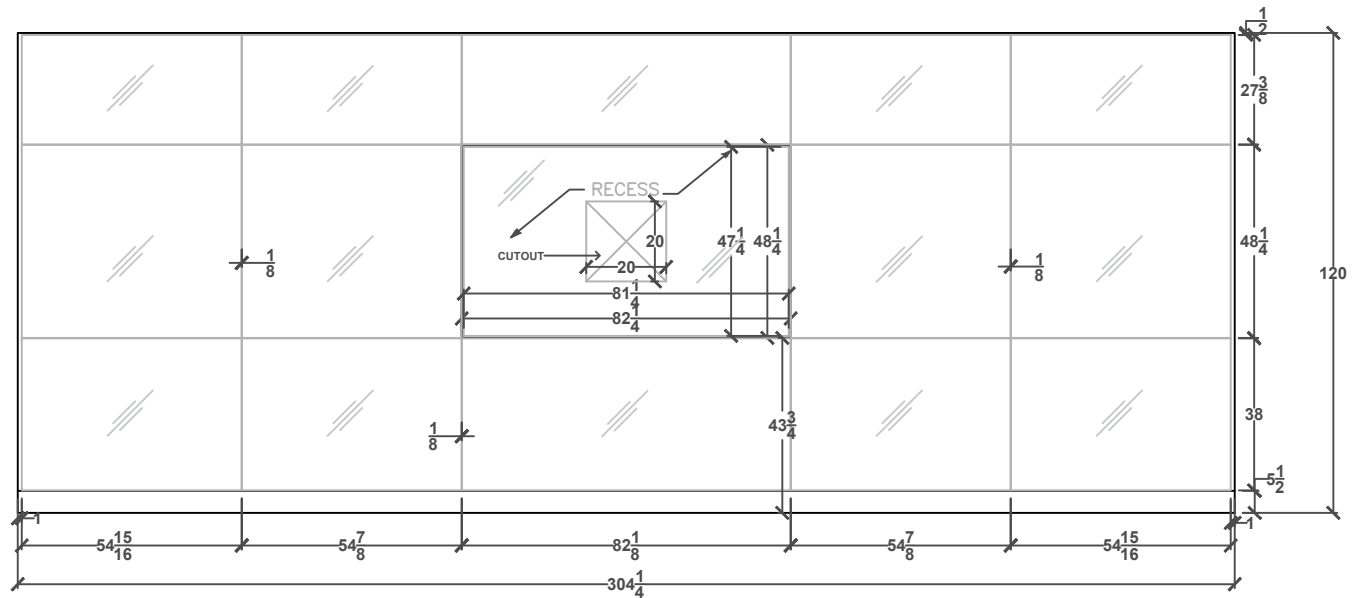

Visual Presentation Drawings

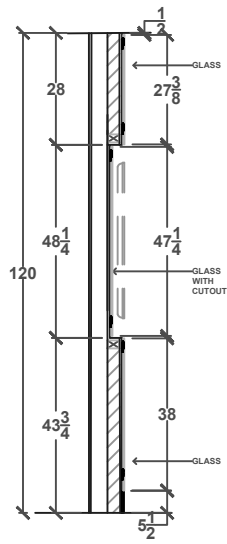

NORTH

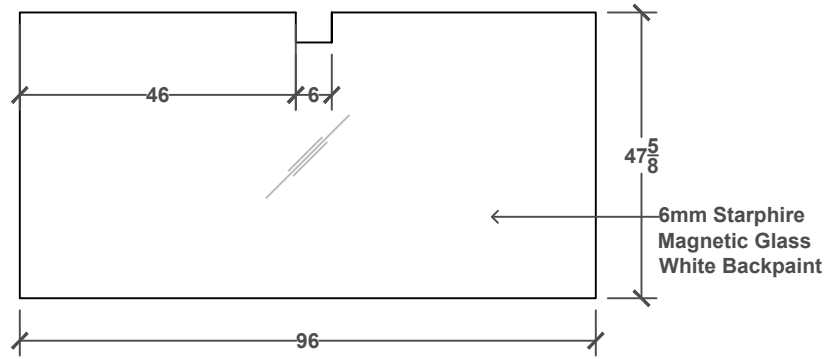

**1** Elevation - Custom Magnetic Glassboard  
3/8" = 1'-0"

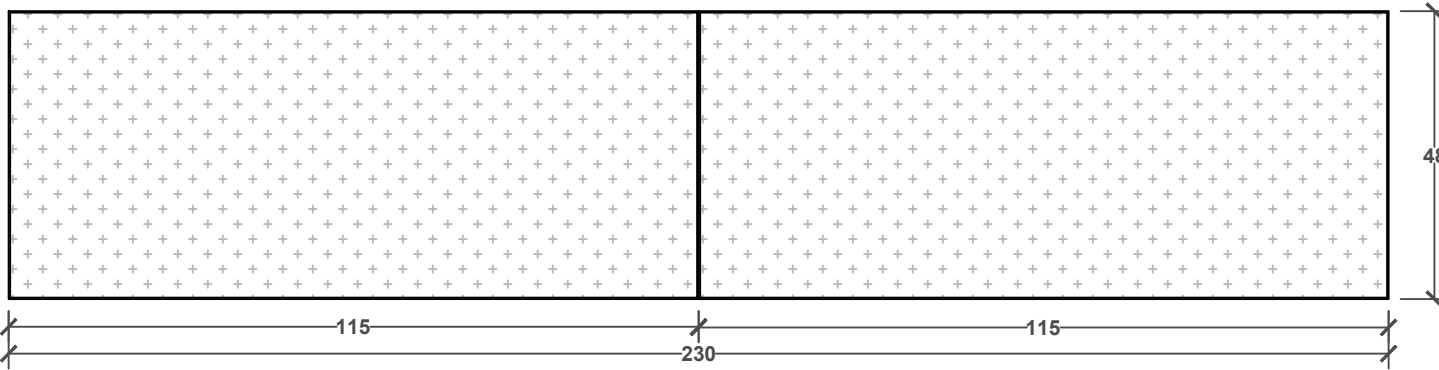

**2** Elevation - Elements Series Noticeboards - Grade 2 Fabric  
3/8" = 1'-0"

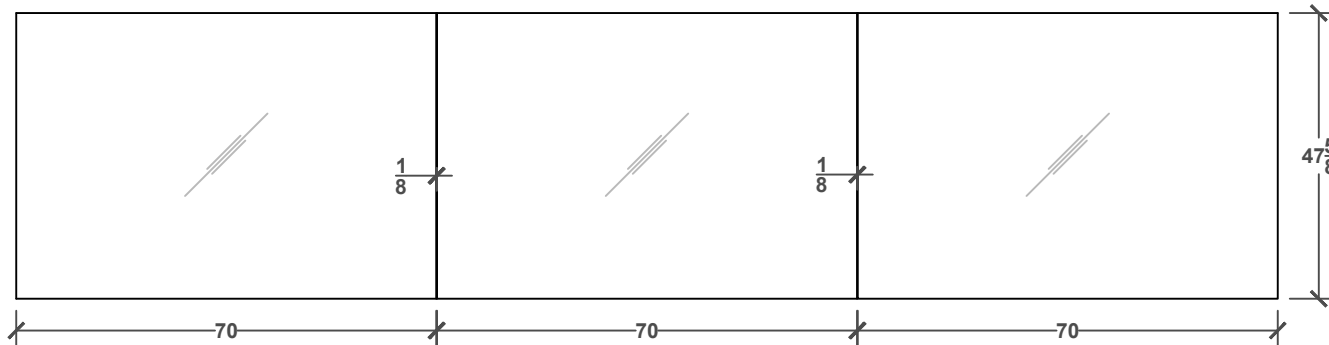

**3** Elevation - Custom Magnetic Glassboards  
3/8" = 1'-0"

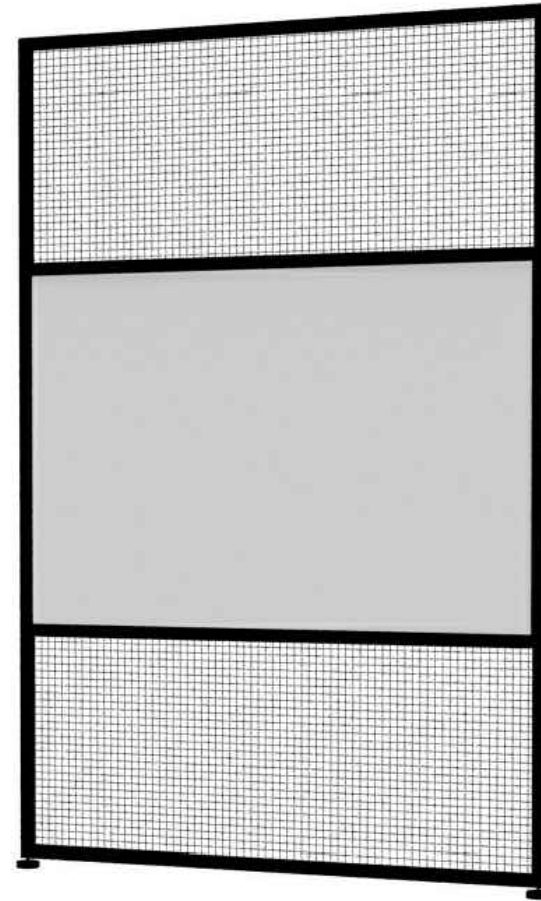
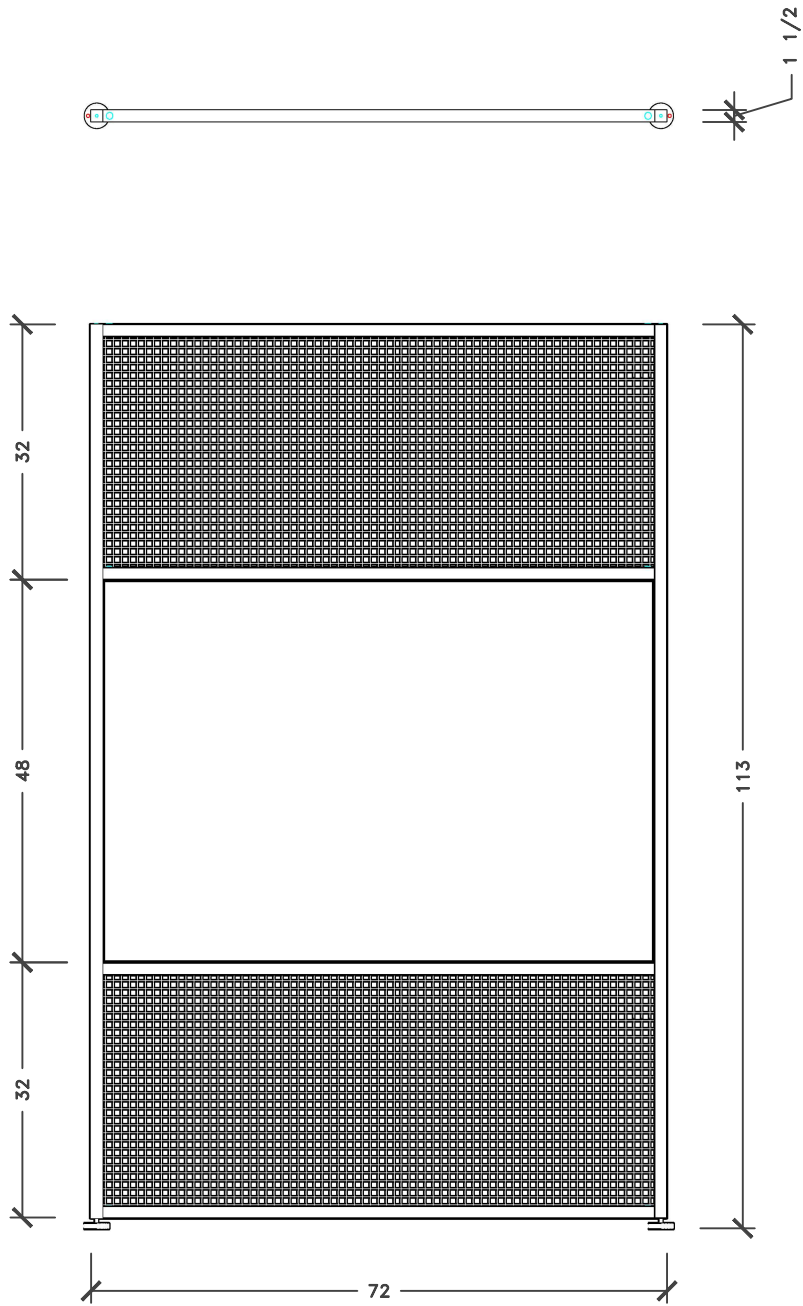

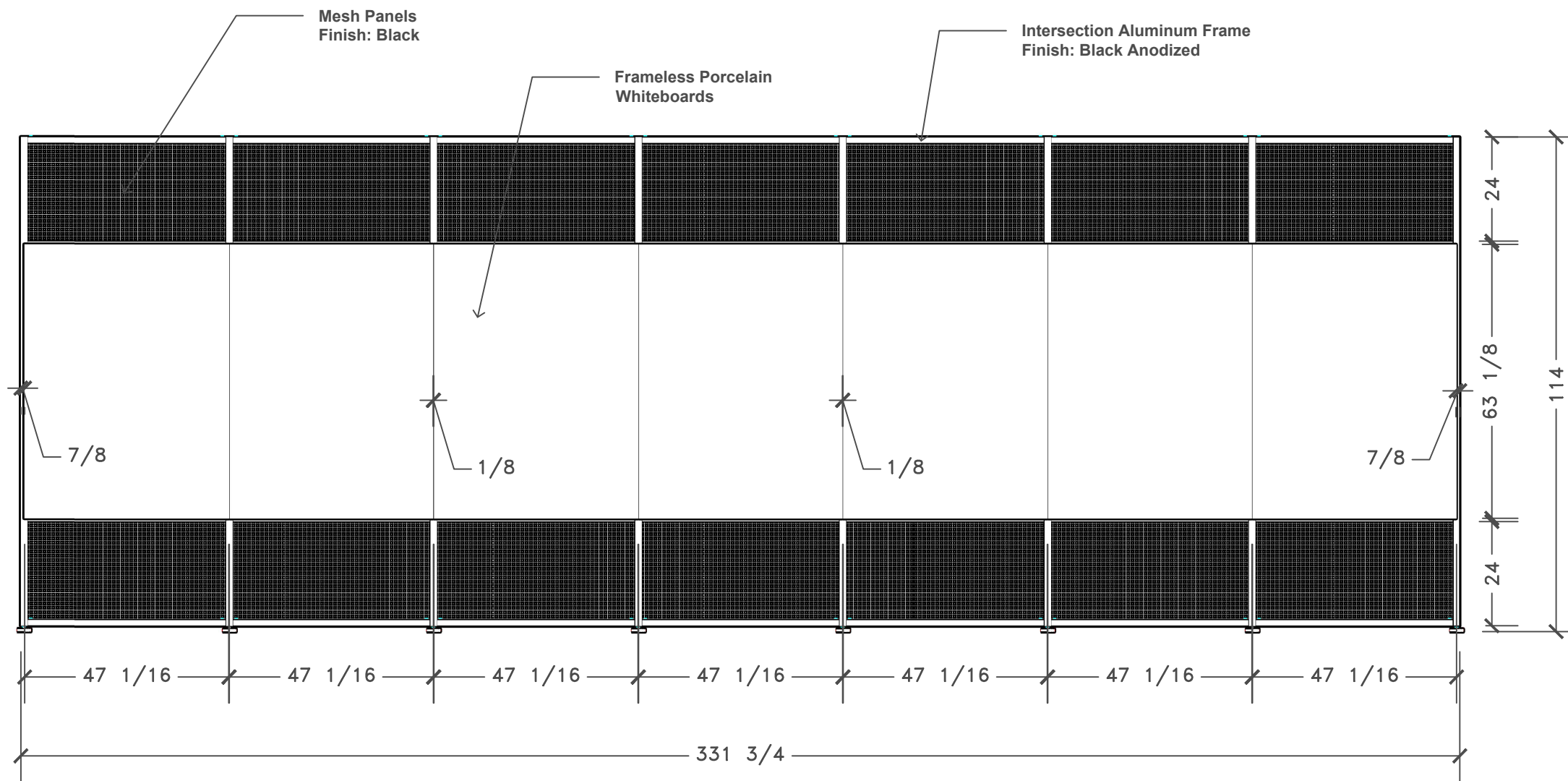

**1** Front Elevation - Custom Intersection Divider with Frameless Whiteboards  
 3/8" = 1'-0" Qty. 2

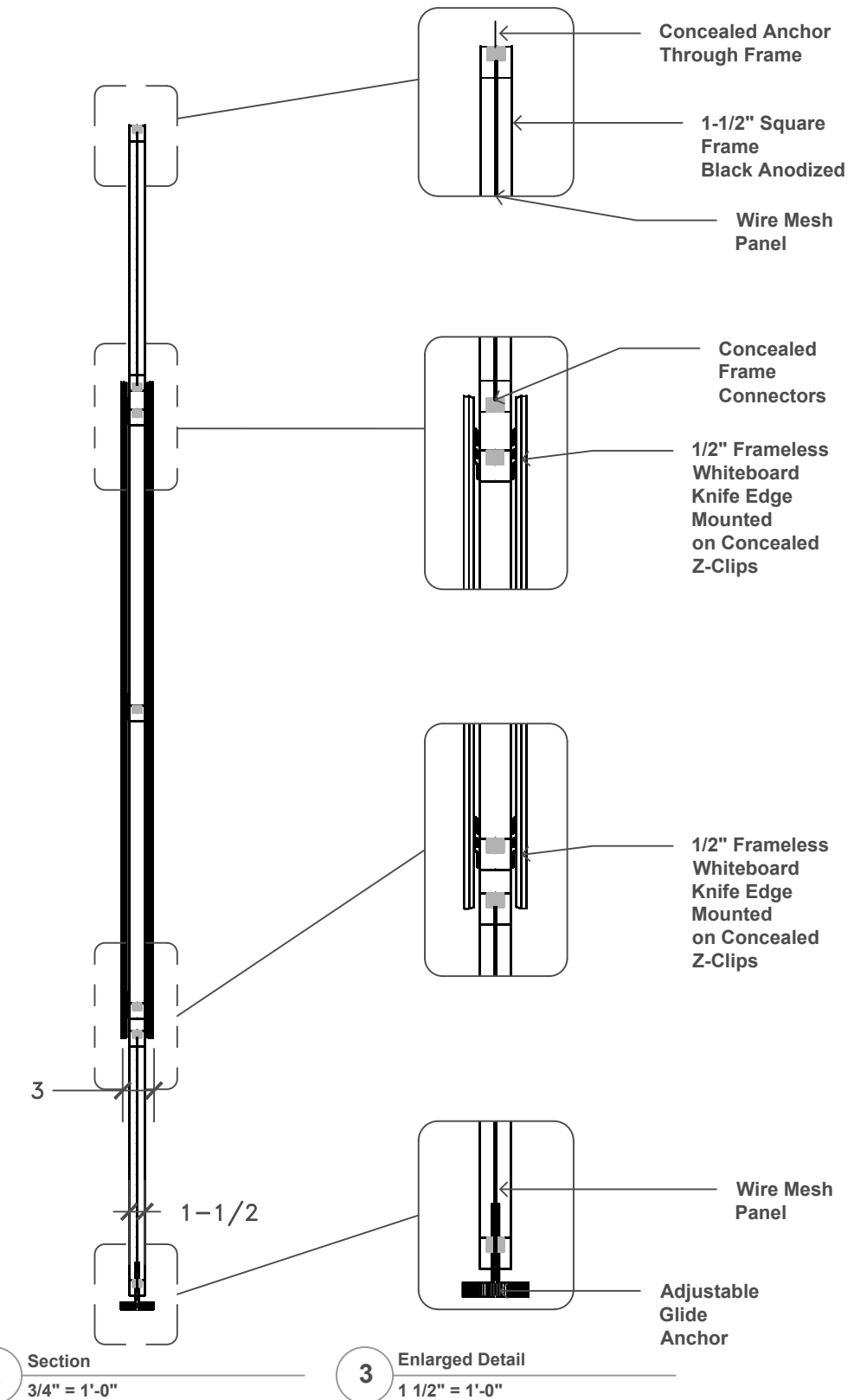

**2** Section  
 3/4" = 1'-0"

**3** Enlarged Detail  
 1 1/2" = 1'-0"

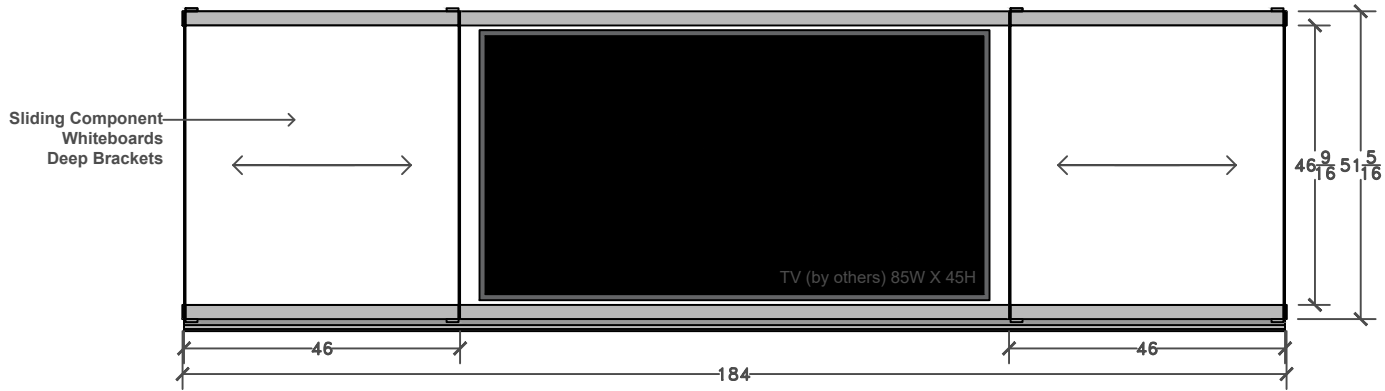

**1** Elevation - VIP Media Wall Rail with (2) Sliding Component Whiteboards - Opened  
 3/8" = 1'-0"

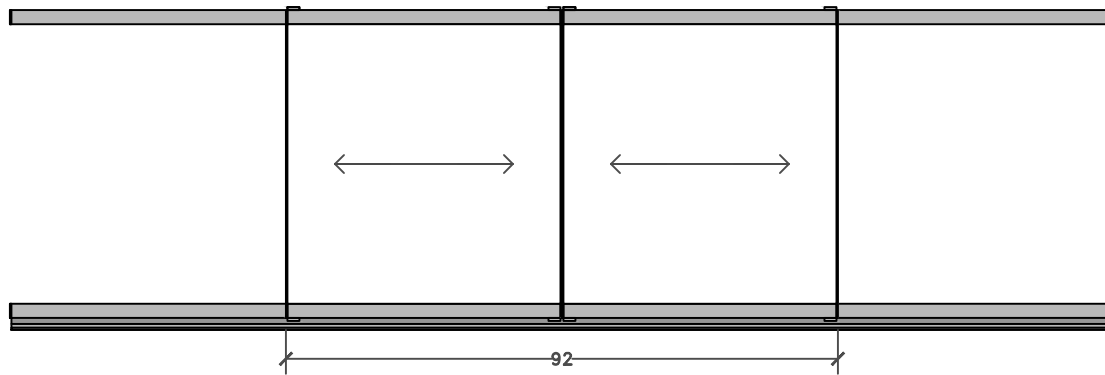

**2** Elevation - VIP Media Wall Rail with (2) Sliding Component Whiteboards - Closed  
 3/8" = 1'-0"

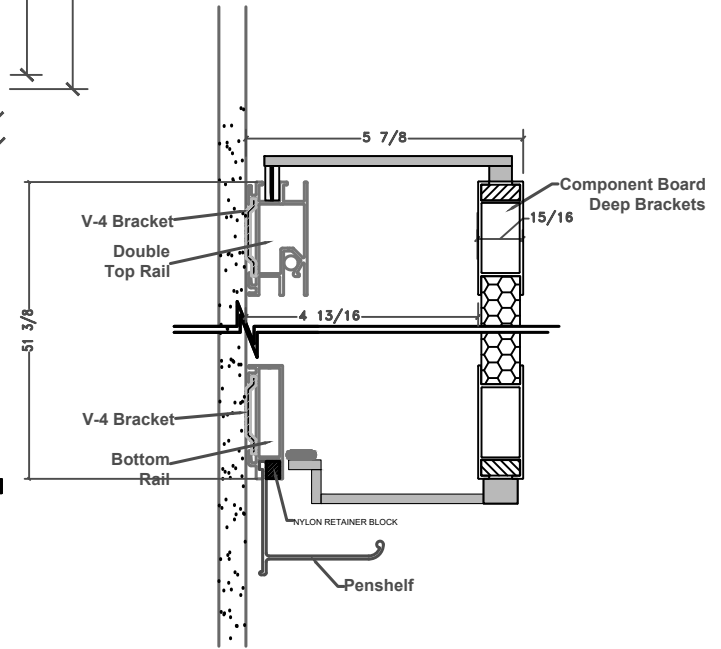

**3** Section  
 3" = 1'-0"

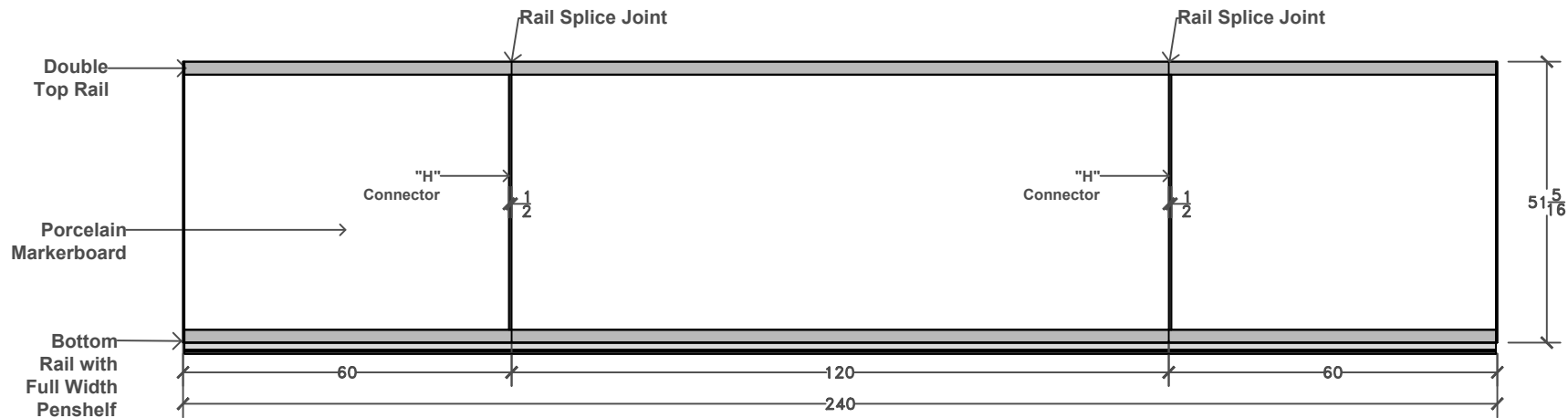

**1a** Elevation - VIP Double Track Porcelain Markerboard - Shown Without Sliding Markerboards  
 3/8" = 1'-0"

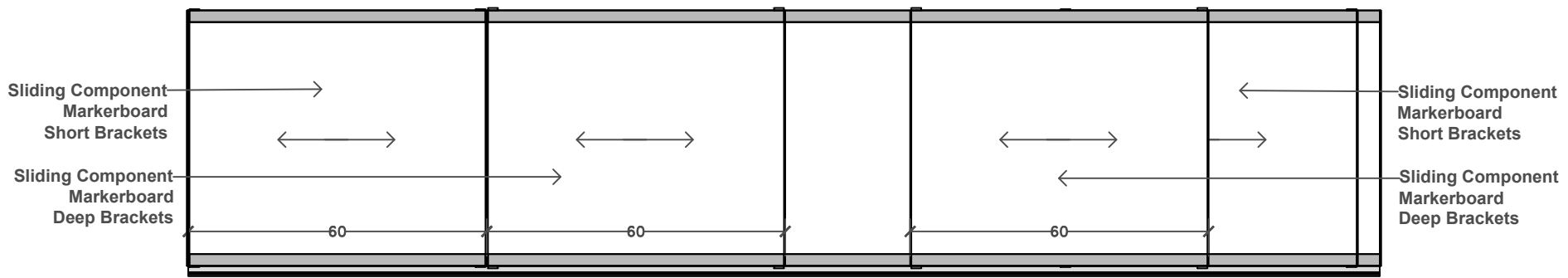

**1b** Elevation - VIP Double Track Porcelain Markerboard - With Sliding Markerboards  
 3/8" = 1'-0"

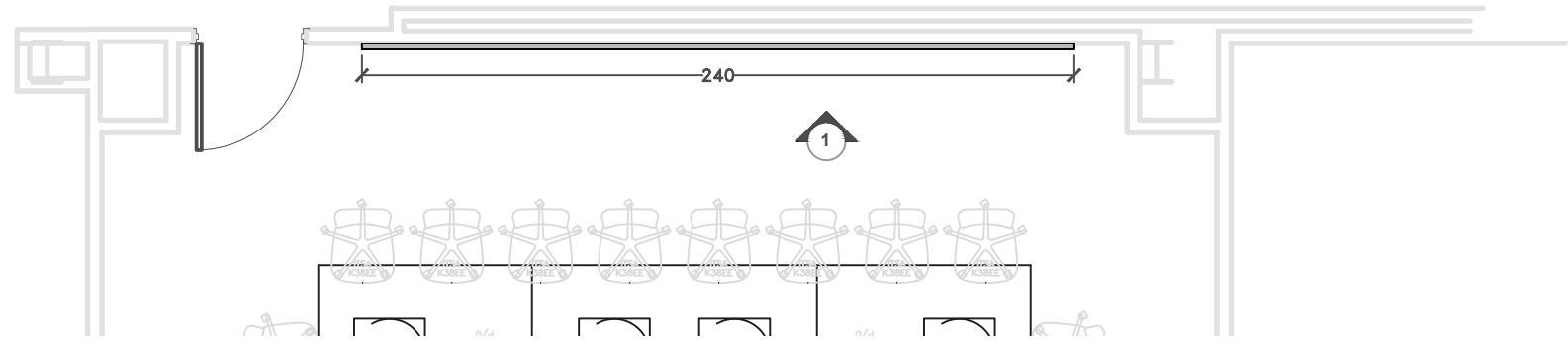

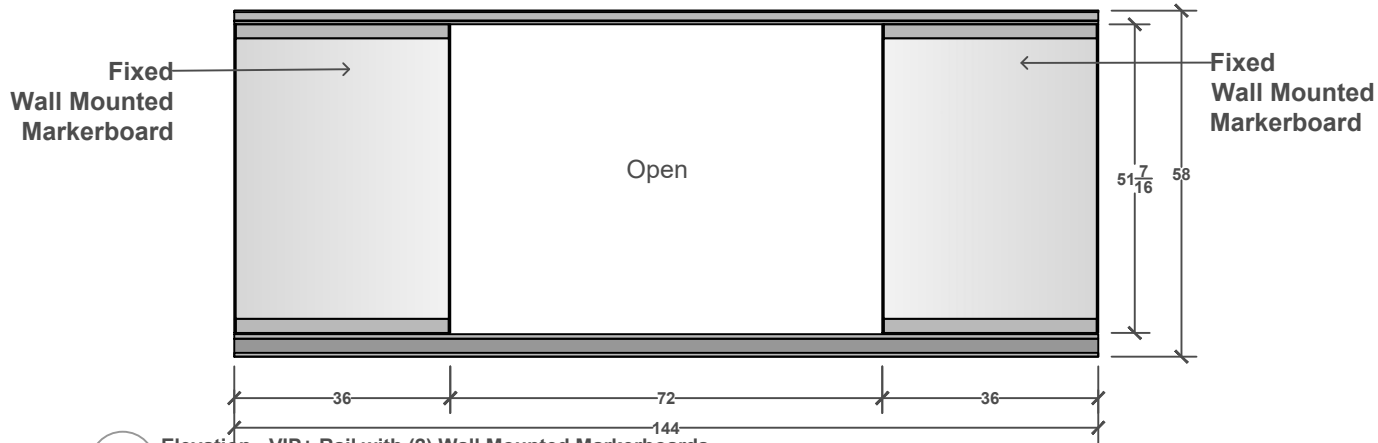

**1** Elevation - VIP+ Rail with (2) Wall Mounted Markerboards  
3/8" = 1'-0"

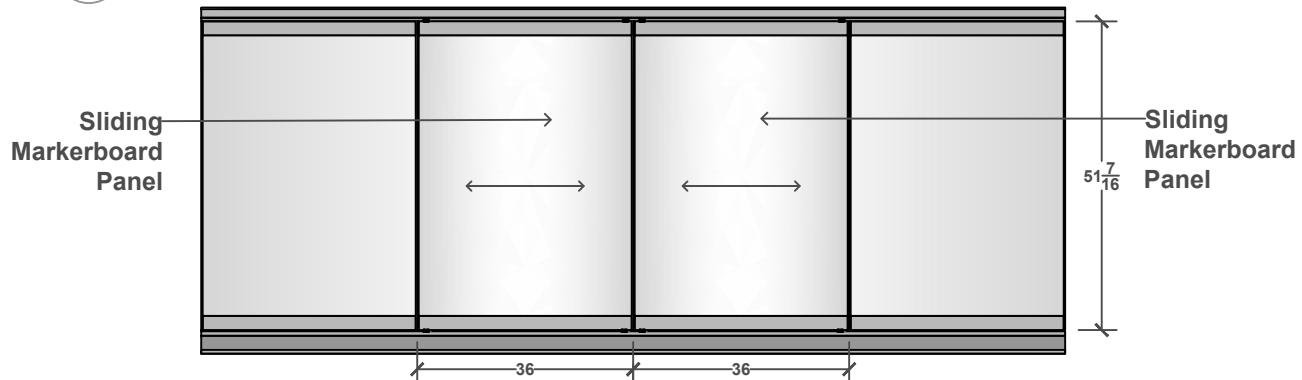

**2** Elevation - VIP+ Rail with (2) Wall Mounted Markerboards and (2) Sliding Markerboards - Closed  
3/8" = 1'-0"

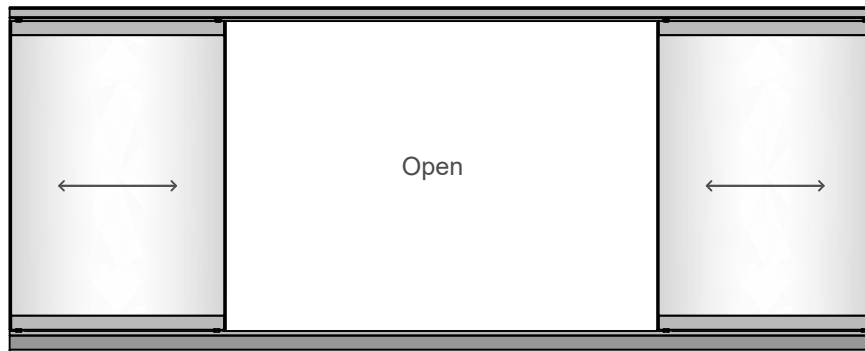

**3** Elevation - VIP+ Rail with (2) Wall Mounted Markerboards and (2) Sliding Markerboards - Opened  
3/8" = 1'-0"

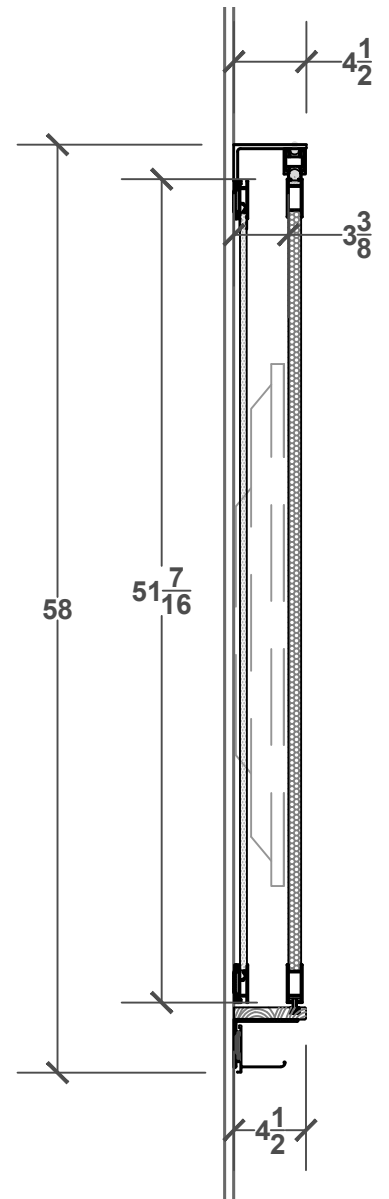

**4** Enlarged Section  
1" = 1'-0"



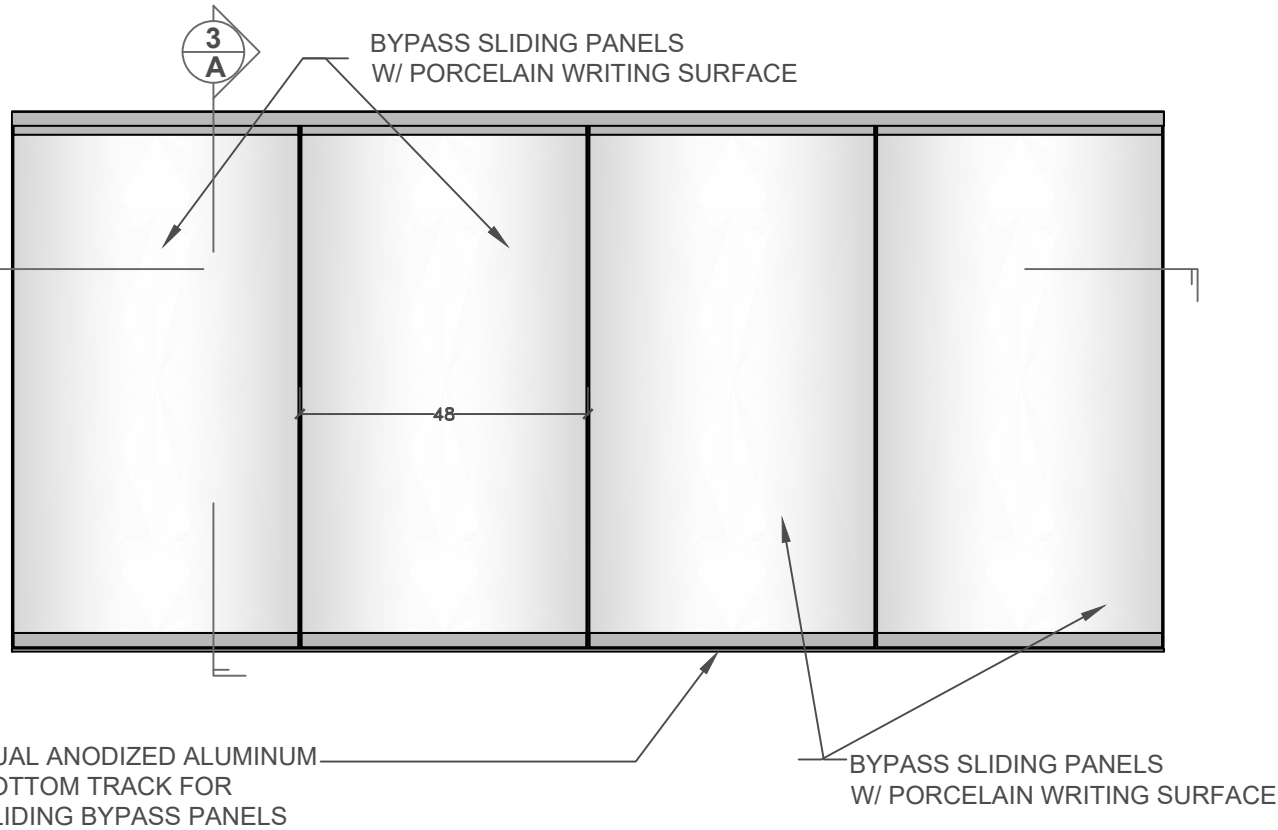

**1**  
**A** **ELEVATION - VIP+ SLIDING MARKERBOARD SYSTEM**  
3/8" = 1'-0"

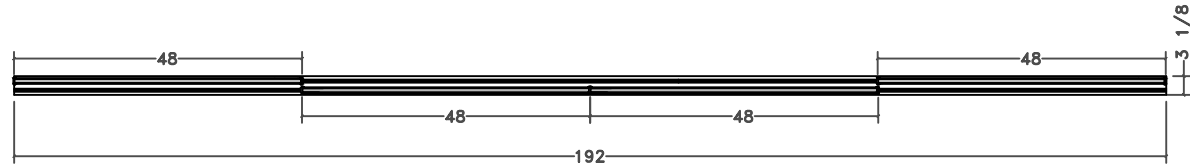

**2**  
**A** **SECTION**  
3/8" = 1'-0"

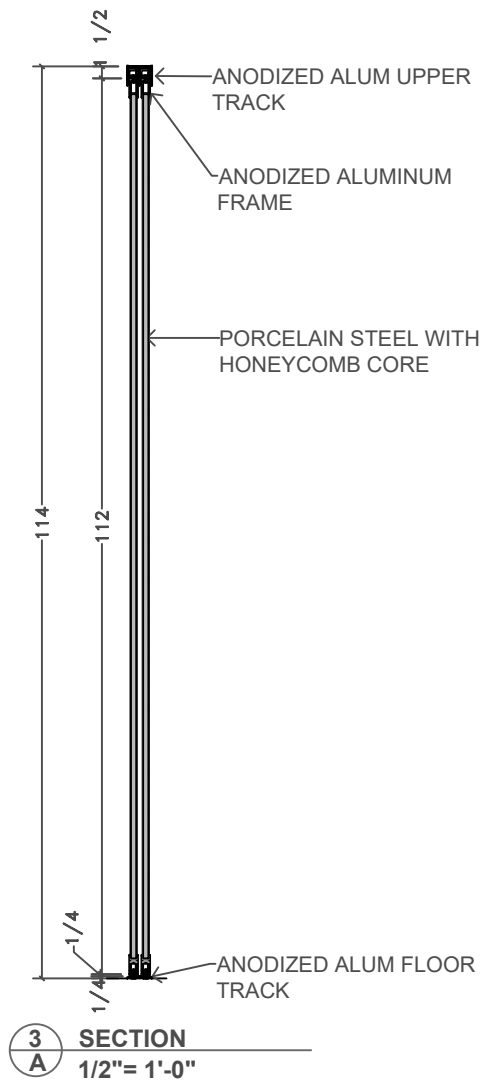

**3**  
**A** **SECTION**  
1/2" = 1'-0"



---

forward thinking solutions

205.941.1942

Birmingham, AL

[info@coronagroupinc.com](mailto:info@coronagroupinc.com)

[coronagroupinc.com](http://coronagroupinc.com)